

**WILLIAM F. WHITE  
INTERNATIONAL INC.  
STUDIOS**



# STUDIOS THAT MATCH YOUR AMBITION.

If you're looking for a studio to shoot your next project in, we've got your back.

William F. White operates state-of-the-art studios in the Vancouver and Toronto area that can handle any size of production. With 31 sound stages and ample mixed-use high-ceiling warehouse space spread across our eight facilities, William F. White Int'l Inc. has over 950,000 square feet of production-ready space.

Our studios offer strategic locations featuring support areas and workshops within the facilities as well as ample crew and base camp parking. Individual studios are equipped with various technical amenities such as the latest in fibre-optic connectivity, creating a modern and comfortable turnkey work environment.

Our other services including camera, lighting, grip, location support and specialty equipment are also within short driving distances of each studio facility.







## TORONTO

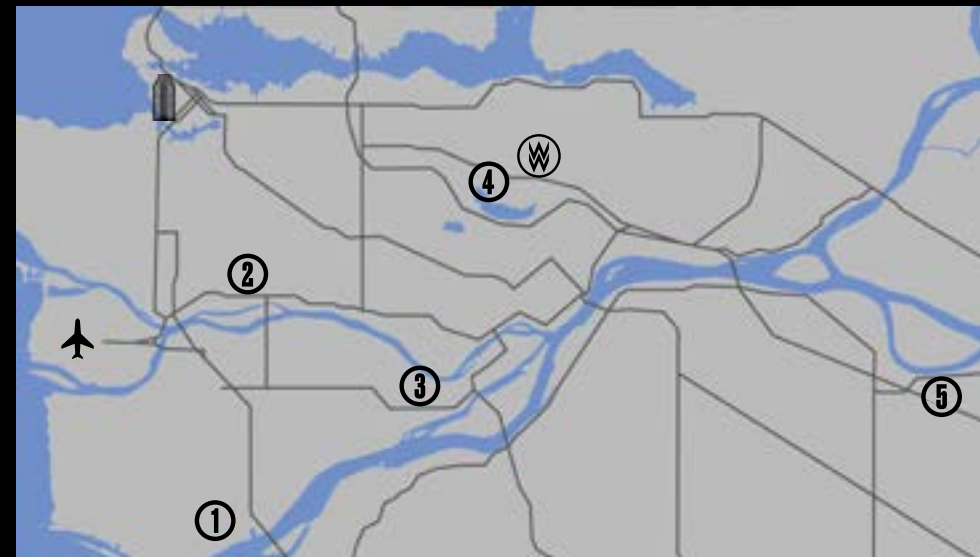

-  Downtown Toronto
-  William F. White International Inc.
-  Edwards Blvd. Studios
-  Cantay Studios NEW

## VANCOUVER



-  Downtown Vancouver
-  William F. White International Inc.
-  Copperwood Studios
-  Ironwood Studios
-  Creekwood Studios
-  Fraserwood Studios
-  Lakewood Flex Space
-  Riverwood Flex Space



## EDWARDS BLVD.

Edwards Blvd. is our first facility located in the Toronto area. The studio offers 151,130 square feet of production-ready space, with 28-foot clear height throughout the building.

Edwards Blvd. houses four sound stages as well as a mill shop, paint shop, two floors of departmental offices and ample storage space.

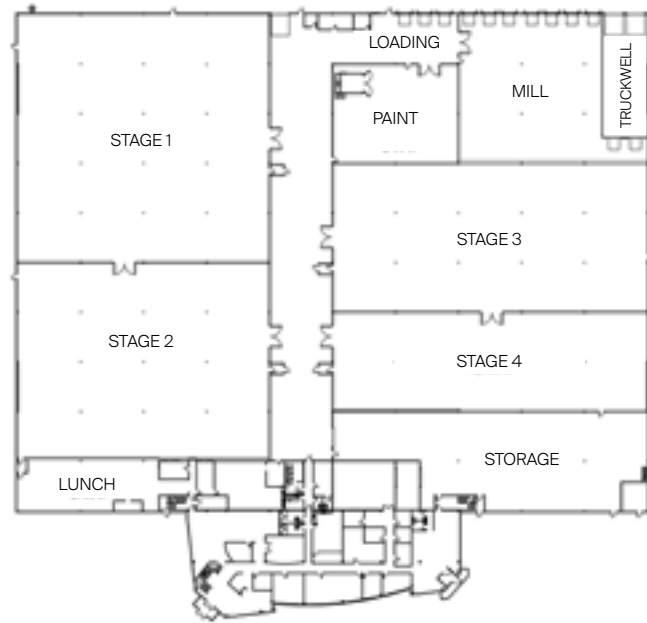

6115 Edwards Boulevard,  
Mississauga, ON

- Stage 1:** 24,800 sq. ft. (160' x 155')
- Stage 2:** 20,000 sq. ft. (160' x 125')
- Stage 3:** 18,400 sq. ft. (198' x 93')
- Stage 4:** 12,400 sq. ft. (198' x 63')
- Mill:** 11,100 sq. ft.
- Paint:** 4,900 sq. ft.
- Production offices:** 21,545 sq. ft.
- Storage:** 10,240 sq. ft.
- Lunch:** 4,700 sq. ft.

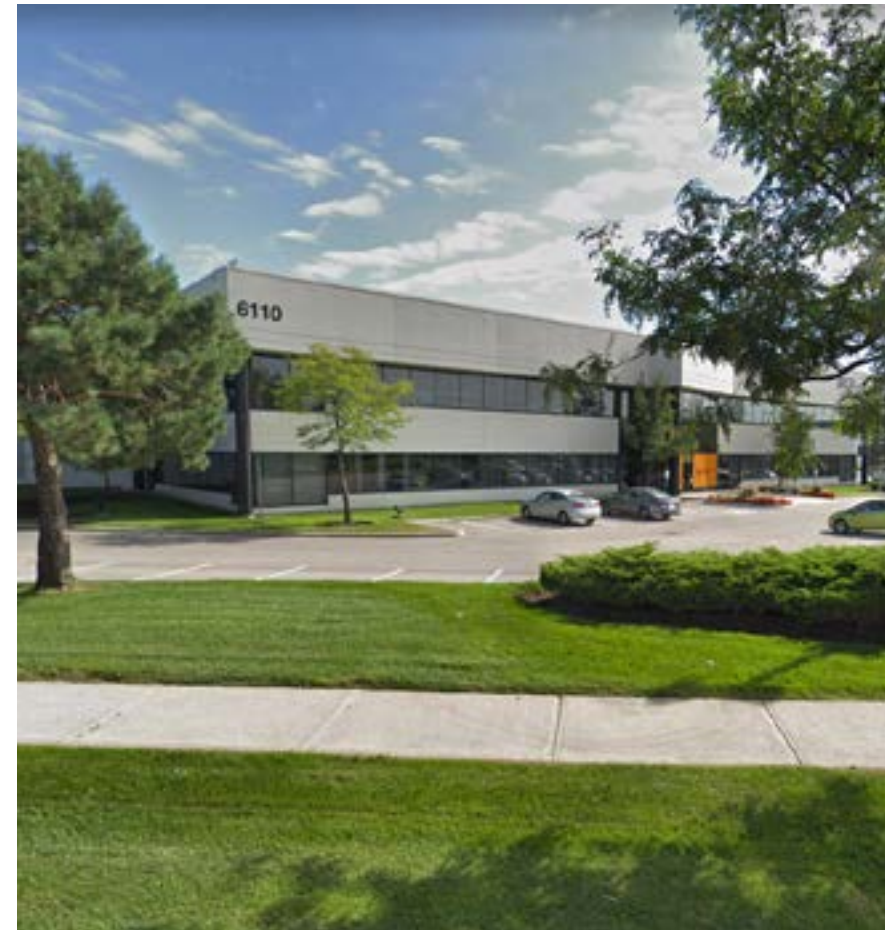

6110 Cantay Rd,  
Mississauga, ON

- Stage 1:** 25,376 sq. ft.
- Stage 2:** 15,000 sq. ft.
- Stage 3:** 17,097 sq. ft.
- Stage 4:** 27,661 sq. ft.

- 1st Floor Offices:** 12,500 sq. ft.
- 2nd Floor Offices:** 12,500 sq. ft.
- Lunch:** 2,176 sq. ft.

- Wardrobe A:** 3,000 sq. ft.
- Wardrobe B:** 3,800 sq. ft.
- Set Dec A:** 1,500 sq. ft.
- Set Dec B:** 1,200 sq. ft.
- Props A:** 1,512 sq. ft.
- Props B:** 1,280 sq. ft.
- Paint A:** 2,835 sq. ft.
- Paint B:** 2,997 sq. ft.
- Mill A:** 9,519 sq. ft.
- Mill B:** 6,318 sq. ft.
- Lock-Up A:** 936 sq. ft.
- Lock-Up B:** 935 sq. ft.

## CANTAY NEW

The newest Toronto Cantay Studio provides clients with a 148,142 square-foot facility complete with four stages, two offices and double the construction space for wardrobe, set dec, props, paint, mill and lock-ups. Cantay will be available for occupancy early 2021.



# COPPERWOOD

Copperwood is a 106,000 square-foot premium, 31-foot clear height, full-service facility located in Richmond. The space provides clients with three large engineered sound stages, a mill shop and paint shop, additional support space, along with ample circus and crew parking. All offices are equipped with fibre-optic services and are fully furnished, providing a modern and comfortable turnkey work environment.

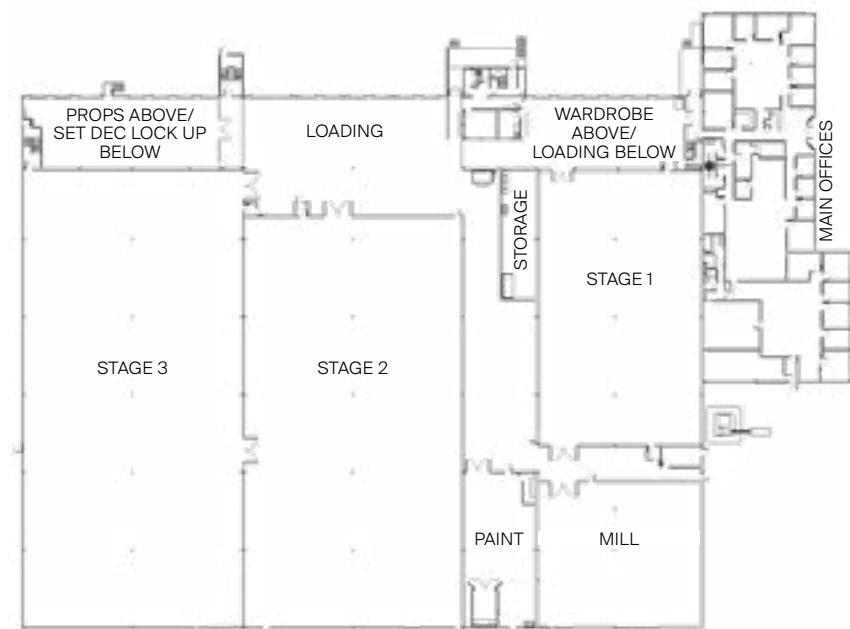

12211 Horseshoe Way,  
Richmond, BC

- Stage 1:** 10,140 sq. ft. (130' x 78')
- Stage 2:** 21,525 sq. ft. (205' x 105')
- Stage 3:** 23,415 sq. ft. (223' x 105')
- Mill:** 5,800 sq. ft.
- Paint:** 2,800 sq. ft.
- Production offices:** 11,580 sq. ft.
- Wardrobe:** 3,977 sq. ft.
- Props:** 3,977 sq. ft.
- Set dec lock-up:** 3,977 sq. ft.

3819 Still Creek Ave,  
Burnaby, BC

- Flex 1:** 10,320 sq. ft. (86' x 120')
- Flex 2:** 14,400 sq. ft. (120' x 120')
- Flex 3:** 5,920 sq. ft. (198' x 29'8")
- Office:** 5,631 sq. ft.

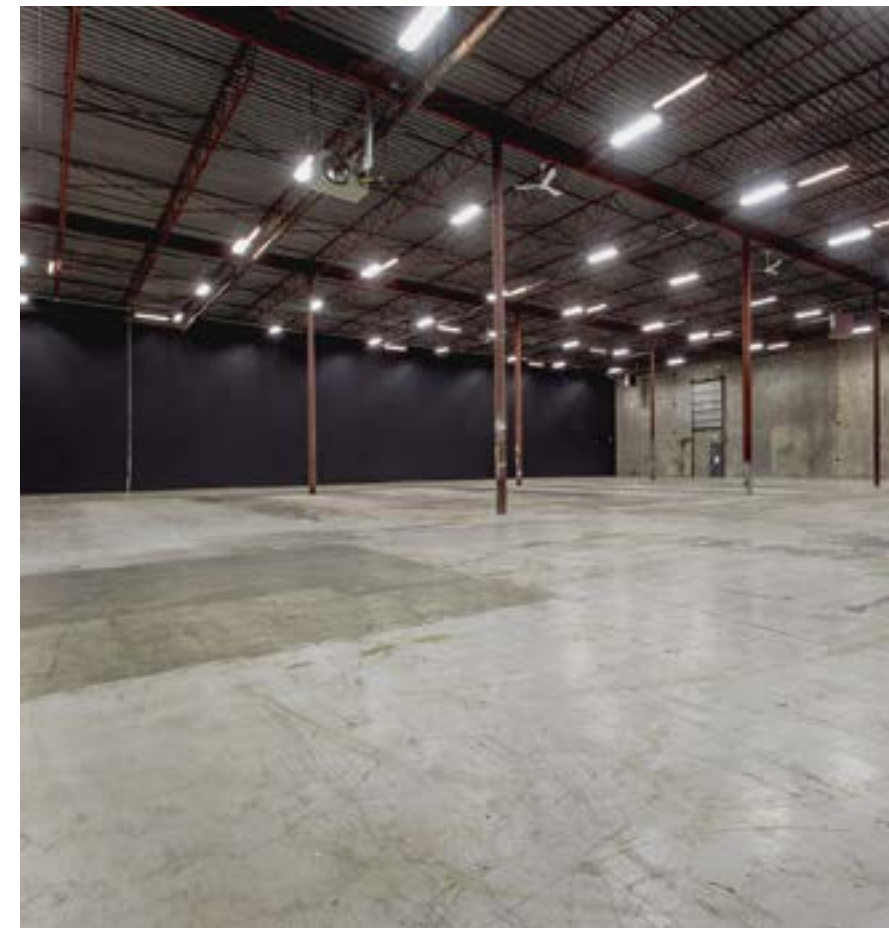
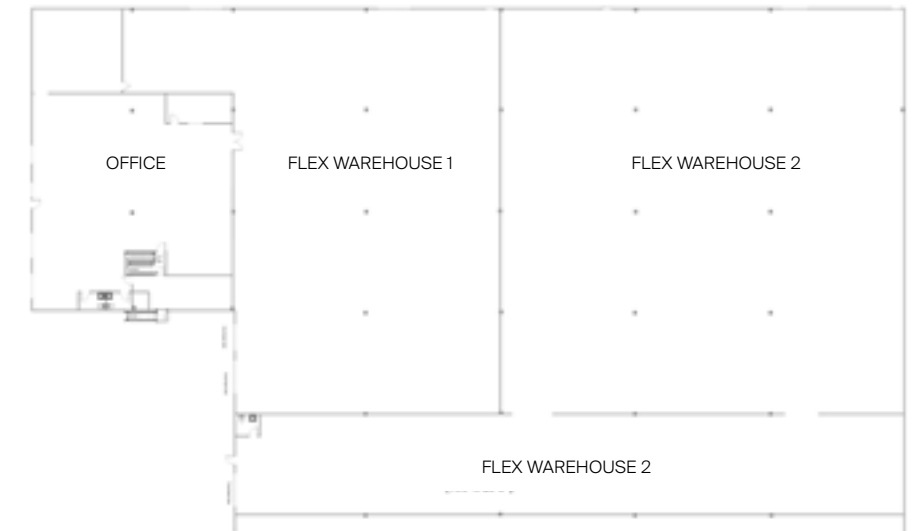

# CREEKWOOD

The Creekwood location is a 36,000 square-foot multipurpose flex space with over 5,500 square-foot of office space and 23' clear ceiling height in the warehouse.

This property features 3 dock doors (2 docks and one drive up), 22 designated parking stalls with access to additional parking, and is a 40 minute drive to YVR International Airport and only 15 minutes to William F. White International.



## FRASERWOOD

Fraserwood offers 25-foot clear height ceilings with four sound stages, a mill shop, paint shop and additional support areas across 119,000 square feet of production-ready space. The studio is located 30 minutes from downtown Vancouver. Fully furnished production offices with fibre-optic connectivity make for a modern turnkey work environment.

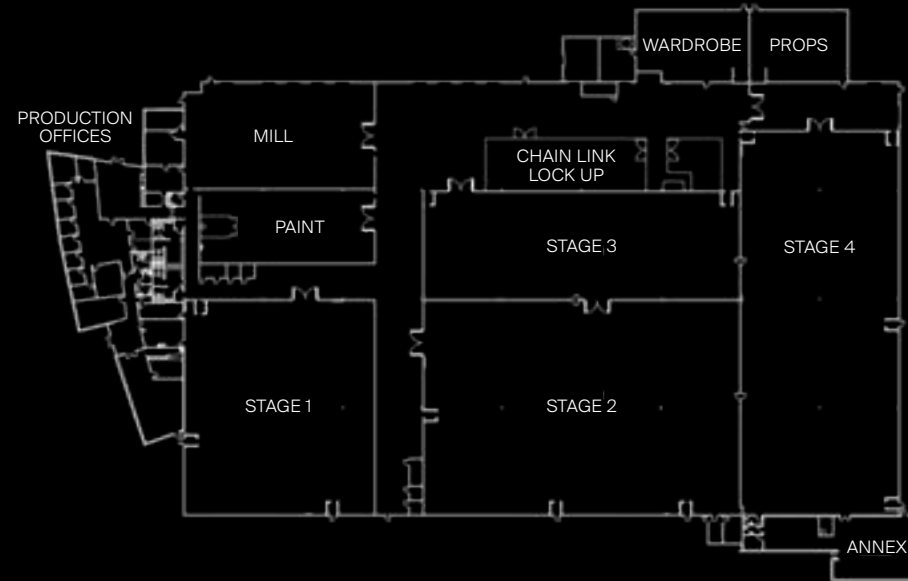

22031 Fraserwood Way,  
Richmond, BC

- Stage 1:** 14,760 sq. ft. (120' x 123')
- Stage 2:** 22,263 sq. ft. (181' x 123')
- Stage 3:** 10,860 sq. ft. (181' x 60')
- Stage 4:** 20,700 sq. ft. (90' x 230')
- Mill:** 7,200 sq. ft.
- Paint:** 5,200 sq. ft.
- Production offices:** 9,200 sq. ft.
- Annex:** 3,200 sq. ft.
- Wardrobe:** 2,600 sq. ft.
- Props:** 2,350 sq. ft.
- Chain link lock-up:** 4,420 sq. ft.

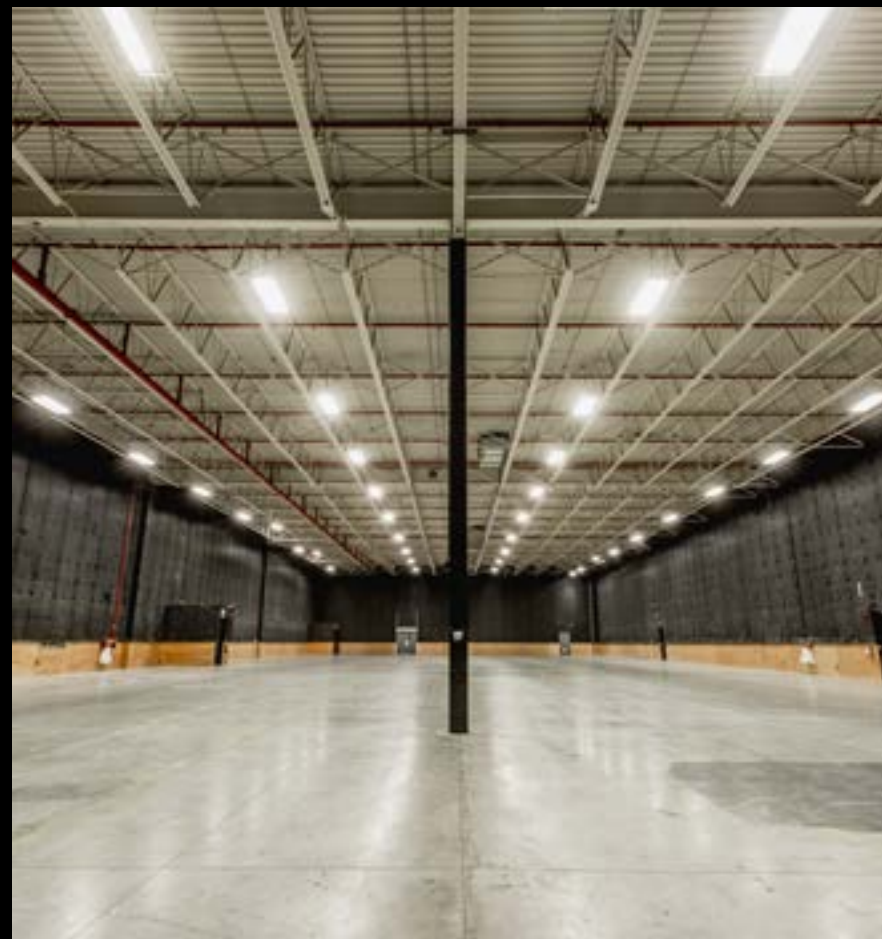

## IRONWOOD

Across 177,000 square feet of production-ready space, Ironwood boasts ceilings of 27 to 31 foot clear height throughout the facility. Ironwood has seven sound stages as well as a mill shop, paint shop, departmental offices, boardrooms and script-reading rooms. Ironwood's fully furnished production offices come equipped with 10 GB fibre-optic service. In addition, our sound stages are equipped with state-of-the-art fibre that complements motion capture and VR systems.

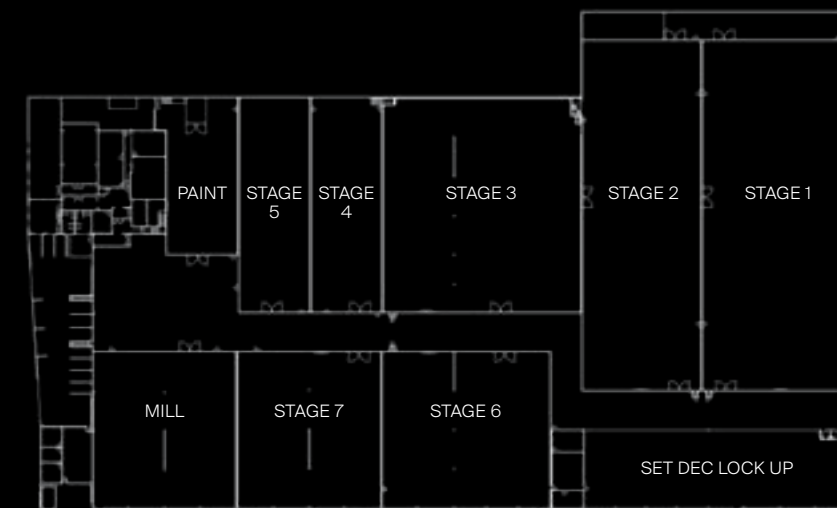

888 SE Marine Drive,  
Vancouver, BC

- Stage 1:** 24,888 sq. ft. (244' x 102')
- Stage 2:** 20,008 sq. ft. (244' x 82')
- Stage 3:** 20,711 sq. ft. (149' x 139')
- Stage 4:** 7,301 sq. ft. (49' x 149')
- Stage 5:** 7,301 sq. ft. (49' x 149')
- Stage 6:** 12,870 sq. ft. (110' x 117')
- Stage 7:** 10,890 sq. ft. (110' x 99')
- Mill shop:** 10,780 sq. ft. (97' x 110')
- Paint shop:** 5,341 sq. ft. (49' x 109')
- Main offices (2nd floor):** 8,355 sq. ft.
- Lower offices:** 8,355 sq. ft.
- Classroom:** 1,500 sq. ft.
- Set dec lock-up:** 10,000 sq. ft.

# LAKWOOD

Lakewood provides clients with a 99,750 square-foot facility complete with four warehouse flex spaces with clear heights ranging from 21 to 24 feet. The location also includes private offices, a boardroom and a kitchenette.



3690 Bainbridge Ave,  
Burnaby, BC

- Flex warehouse 1:** 25,330 sq. ft.
- Flex warehouse 2:** 23,139 sq. ft.
- Flex warehouse 3:** 24,633 sq. ft.
- Flex warehouse 4:** 21,864 sq. ft.
- Offices:** 3,303 sq. ft.

\*The above figures represent the dimensions of each warehouse at its widest point.\*

# RIVERWOOD

Riverwood presents clients with a 97,430 square-foot facility complete with two 20-foot clear height warehouse flex spaces. The building also includes an office mezzanine, as well as paint and construction workspaces.

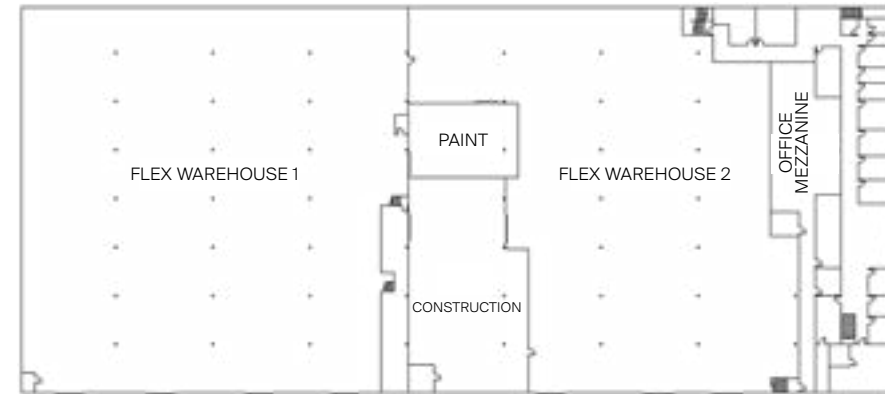

18788 96 Ave,  
Surrey, BC

- Flex warehouse 1:** 39,500 sq. ft.
- Flex warehouse 2:** 38,100 sq. ft.
- Paint:** 2,100 sq. ft.
- Construction:** 6,100 sq. ft.
- Office mezzanine:** 12,000 sq. ft.





# STAGE SPECIFICATIONS

Stage	Sq. Footage	Column Spacing	Clear Height	400-Amp Cam-Lock Panels	200-Amp House Panel	200,000 BTU Gas-Fired Heater	10,000 CFM Extraction Fans
<b>Copperwood - Richmond, BC</b>							
1	10,140 sf	40' x 37'	31'	2	✓	✓	1
2	21,525 sf	52' x 37'	31'	3	✓	✓	2
3	23,415 sf	52' x 37'	31'	3	✓	✓	2
<b>Edwards Blvd. - Toronto, ON</b>							
1	24,800 sf	40' x 32'	28'	2	✓	✓	2
2	20,000 sf	40' x 32'	28'	2	✓	✓	2
3	18,400 sf	40' x 32'	28'	2	✓	✓	2
4	12,400 sf	40' x 32'	28'	1	✓	✓	1
<b>Fraserwood - Richmond, BC</b>							
1	14,760 sf	60' x 45'	25'	2	✓	✓	2
2	22,263 sf	60' x 45'	25'	2	✓	✓	2
3	10,860 sf	Clear span	25'	2	✓	✓	2
4	20,700 sf	60' x 45'	25'	2	✓	✓	2
<b>Ironwood - Vancouver, BC</b>							
1	24,888 sf	Clear span	31'	2	✓	✓	3
2	20,008 sf	Clear span	29'	2	✓	✓	3
3	20,711 sf	87' x 26'	27'	2	✓	✓	2
4	7,301 sf	Clear span	27'	1	✓		
5	7,301 sf	Clear span	27'	1	✓		
6	12,870 sf	66' x 26'	27'	2	✓	✓	1
7	10,890 sf	49' x 26'	27'	2	✓	✓	
<b>Lakewood - Burnaby, BC</b>							
1	25,330 sf	Clear span	22'				
2	23,139 sf	Clear span	20'6"				
3	24,633 sf	33' x 29'	22'				
4	21,864 sf	40' x 35'	24'				
<b>Riverwood - Surrey, BC</b>							
1	39,500 sf	50' x 25'	20'				
2	38,100 sf	50' x 25'	20'				

# WE'VE GOT ALL YOUR BASES COVERED

For more than 57 years, William F. White International Inc. has equipped Canadian film and television productions with the most comprehensive and technologically advanced rental inventory in the country.

As Canada's only national equipment provider, we're committed to supporting productions of all kinds: tentpole studio feature films, experimental proof-of-concept web shorts and everything in between.

From state-of-the-art studio spaces to the latest cameras, specialty equipment, lighting, grip, expendables and location support, we maintain all our rentals to the highest possible standards. And we make sure you get what you need, when you need it, with six rental facilities strategically located across the country. Whites Studios also offers management and consulting packages for bundling our services and studio buildouts.

Talk with us today or visit us online at [whites.com](http://whites.com) to see how we can be your partners in production the next time you film in Canada.

Provided services:

**LIGHTING & GRIP**

**CAMERA**

**SPECIALTY EQUIPMENT**

**LOCATION EQUIPMENT SUPPLY**

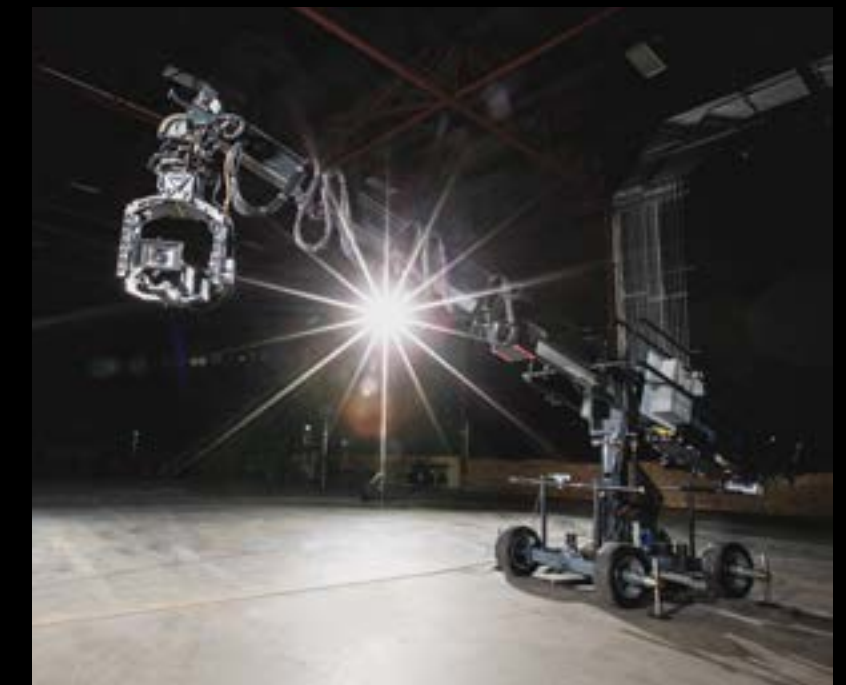

# DROP BY AND SAY HELLO.

Find us in six locations across Canada.

## VANCOUVER

100-8363 Lougheed Highway  
Burnaby, BC V5A 1X3

Hours: Mon-Fri, 8am-5pm PT

Tel: +1 604 253 5050

After-hours Emergencies: +1 604 838 2747

Randall Plitt: rplitt@whites.com

Whites Specialty Equipment—Western  
Canada

3555 Bainbridge Avenue

Burnaby, BC V5A 2T3

Hours: Mon-Fri, 8am-5pm PT

Tel: +1 604 428 2144

Barrie Wells: bwells@whites.com

Whites LES Vancouver

3975 Kitchener Street

Burnaby, BC V5C 3L9

Hours: Mon-Fri, 8am-7pm PT

Tel: +1 604 436 1418

Fax: +1 604 436 1461

Email: wlesvancouver@whites.com

Jason Cox: jcox@whites.com

## CALGARY

Calgary Film Centre

5750 76th Avenue SE, Unit 50

Calgary, AB T2C 5N5

Hours: Mon-Fri, 8am-5pm MT

Tel: +1 403 279 2693

Sean Toner: seant@whites.com

## WINNIPEG

11-2073 Logan Avenue

Winnipeg, MB R2R 0J1

Hours: Mon-Fri, 8am-5pm CT

Tel: +1 204 774 7903

Craig Aftanas: caftanas@whites.com

## SUDBURY

922 Cambrian Heights Drive, Unit 2

Sudbury, ON P3C 5L8

Hours: Mon-Fri, 8am-5pm ET

Tel: +1 705 885 1242

Josh Desormeaux: jdesormeaux@whites.com

## TORONTO

800 Islington Avenue

Toronto, ON M8Z 6A1

Hours: Mon-Fri, 8am-5pm ET

Tel: +1 416 239 5050

After-hours Emergencies: +1 647 222 0454

Michael Drabot: mdrabot@whites.com

Whites Camera

Hours: Mon-Fri, 8am-6pm ET

After-hours Emergencies: +1 416 522 4285

Trevor Huys: thuys@whites.com

Whites LES Toronto

Hours: Mon-Fri, 7:30am-5:30pm ET

Tel: +1 416 410 5858

Email: wlestoronto@whites.com

Paul Potvin: ppotvin@whites.com

The Store @ Whites (Expendables)

Hours: Mon-Fri, 8am-5pm ET

thestore@whites.com

## HALIFAX

180 Thornhill Drive, Unit 3

Dartmouth, NS B3B 1V3

Hours: Mon-Fri, 8am-5pm AT

Tel: +1 902 450 1284

Trevor Sutherland: tsutherland@whites.com

whites.com

whitesstudios.com

whitesles.com

