



IRONWOOD STUDIO

Spread across 177,000 square feet of production-ready space, Ironwood Studio boasts ceilings of 27 to 31 feet clear height and 25 feet to clear span of column spacing throughout the facility. Ironwood has seven sound stages as well as a mill shop, a paint shop, departmental offices, boardrooms, and script-reading rooms. Ironwood's fully furnished production offices come equipped with 10 GB fibre-optic service. In addition, the sound stages are equipped with state-of-the-art fibre that complements motion capture and VR systems.







 888 SE Marine Drive, Vancouver, BC

[View on Map](#)

HIGHLIGHTS

- Production office with IP phones
- 10 GB fibre-optic service
- Kitchen complete with fridge and dishwasher
- Full service paint shop, complete with paint spray booth
- Mill shop
- Set decoration and props lockups
- Professional wardrobe breakdown, changerooms and sewing room

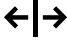
FEATURES

-  100 Parking Spots
-  27' - 31' Ceiling Height
-  25' Column Spacing
-  2,200 Amps
-  **Nearby:**
 - 10 minutes from YVR International Airport
 - 12 mins from WFW Copperwood Studio
 - 14 mins from WFW Fraserwood Studio
 - 15 mins from Downtown Vancouver
 - 20 mins from WFW

FLOOR PLAN

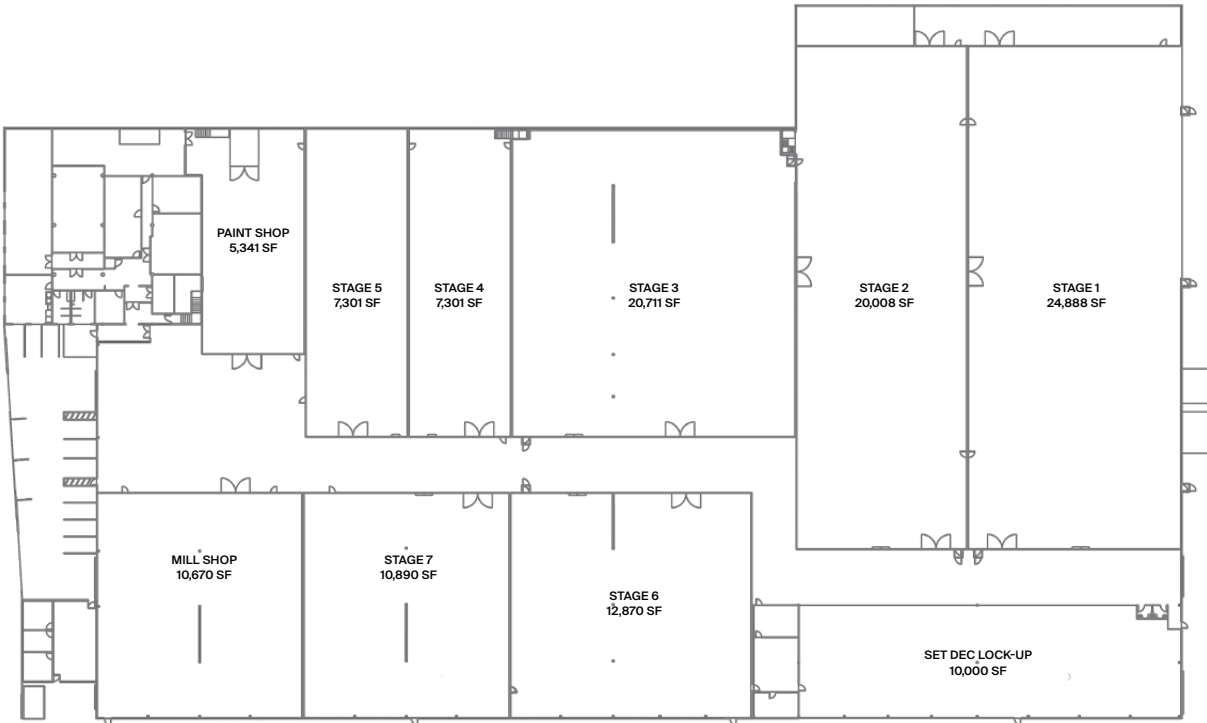

BUILDING SPECS

Stage 1:	24,888 sq.ft.
Stage 2:	20,008 sq.ft.
Stage 3:	20,711 sq.ft.
Stage 4:	7,301 sq.ft.
Stage 5:	7,301 sq.ft.
Stage 6:	12,870 sq.ft.
Stage 7:	10,890 sq.ft.

Total Stage Space: 103,969 sq.ft.

Mill Shop:	10,670 sq.ft.
Paint Shop:	5,341 sq.ft.
2 nd Floor Offices:	8,355 sq.ft.
Lower Offices:	8,355 sq.ft.
Classroom:	1,500 sq.ft.
Set Dec Lock-up:	10,000 sq.ft.

Total Support Space: 44,221 sq.ft.

